

DATA SHEET:

D5.1.N

1" STOPPING PLUG

TYPE 'D' STOPPING PLUGS ARE USED TO SEAL UNUSED CABLE GLAND OR CONDUIT ENTRIES IN EX APPROVED ENCLOSURES, MAINTAINING THE HAZARDOUS LOCATION CERTIFICATION AND THE OVERALL INTEGRITY OF THE INSTALLATION.



www.hlsus.com

Type D5
NPT Taper

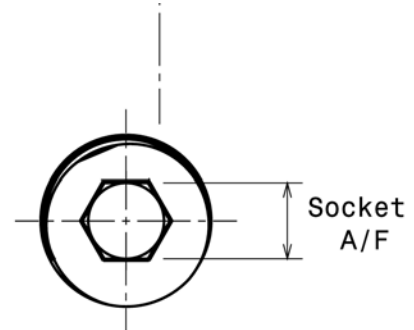
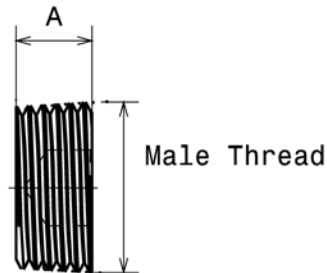

Approvals & Specifications

ATEX Exd IIC Gb / Ex tb IIIC Db IP6X
IECEX EN/IEC 60079-0, EN/IEC 60079-1, EN/IEC 60079-31
ATEX/94/9/EC

NEC/CEC **Class I, Division 1 Groups ABCD**
Class II, Groups EFG, Class III
(>M50 Groups CD only)
UL1203, UL514B, UL50
C22.2 Nos. 30, 0.5, 0-M, 45, 18.3-04, 94-M91
AExd IIC Class I, Zone 1
E60079-0UL2279, UL60079-0, UL60079-1, UL60079-1-1
E60079-1, E60079-1-1

Thread Gauging NPT: Male L1 +/-1 Turns

Material Options Nickel Plated Brass 'N' (-100 to + 150C)

Ingress Protection With Thread Sealant (Non-Hardening)
IP66/68 & NEMA 4X

Impact Resistance 7Nm

Dimensions

Part Number	D5.1.N
Male Thread	1"NPT-16
Male Thread Length 'A'	0.699" (17.5mm)
Socket A/F	10mm