

DATA SHEET:

# R1.3/4.20.N

## 3/4" X 20MM REDUCER



www.hlsus.com

EX APPROVED REDUCERS ARE USED TO MATCH ENCLOSURE ENTRY THREADS WITH THE CABLE GLAND OR CONDUIT WHEN THE THREADS DIFFER, MAINTAINING THE HAZARDOUS LOCATION CERTIFICATION AND THE OVERALL INTEGRITY OF THE INSTALLATION.

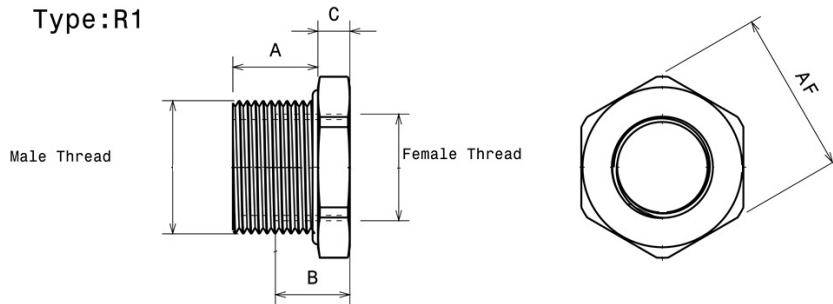

## Approvals & Specifications

ATEX/IECEx Exd IIC Gb / Exe IIC Gb / Extb IIIC Db, IP66

EN/IEC 60079-0, EN/IEC 60079-1, EN/IEC 60079-7,  
EN/IEC 60079-31, ATEX/94/9/EC

NEC/CEC Class I, Division 1 Groups ABCD

**Class II, Groups EFG, Class III**

UL1203, UL514B, UL50  
C22.2 Nos. 30, 0.5, 0-M, 45, 18.3-04, 94-M91

**AExd IIC / AExe II Class I, Zone 1**

UL2279, UL60079-0, UL60079-1, UL60079-7, UL60079-1-1  
E60079-0, E60079-1, E60079-7, E60079-1-1

Thread NPT: Male L1 +/-1 Turn

Gauging Female L1+ 1/2 to + 2 Turns

Material **Nickel Plated Brass (-100 to +150**

Ingress **With Thread Sealant (Non-Hardening)**

Protection **IP66/68 NEMA 4X**

Impact **7Nm**

Resistance

## Dimensions

Part Number	R1.3/4.20.N
Male Thread	3/4" NPT
Male Thread Length 'A'	20mm (.787")
Female Thread	M20
Female Thread Depth 'B'	26.99MM (1.1/16")
Hexagon A/F	26.99MM (1.1/16")
Body Length 'C'	6MM (0.236")