

DATA SHEET:

N.1/2.1/2.N

ADAPTOR

EX APPROVED ADAPTORS ARE USED TO MATCH ENCLOSURE ENTRY THREADS WITH THE CABLE GLAND OR CONDUIT WHEN THE THREADS DIFFER, MAINTAINING THE HAZARDOUS LOCATION CERTIFICATION AND THE OVERALL INTEGRITY OF THE INSTALLATION.



www.hlsus.com

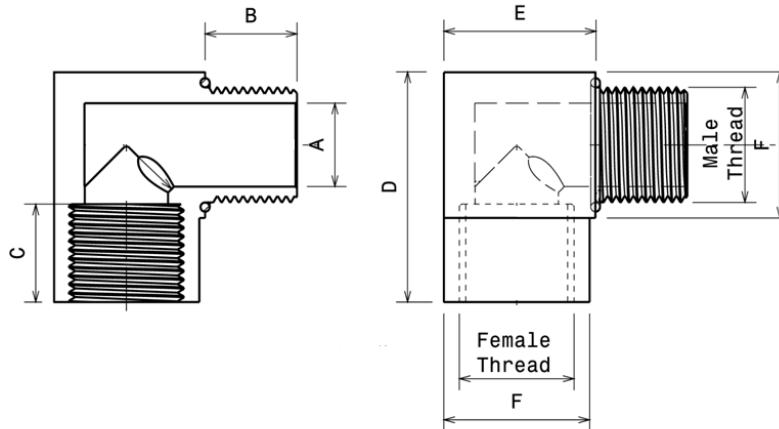

Approvals & Specifications

ATEX/IEC Exd IIC Gb / Exe IIC Gb / Ex tb IIIC Db, IP6X
EN/IEC 60079-0, EN/IEC 60079-1, EN/IEC 60079-7,
EN/IEC 60079031, ATEX/2014/34/EU

NEC/CEC Class I, Division 1 Groups ABCD
Class II, EFG, Class III
UL1203, UL514B, UL50
C22.2 Nos. 30, 0.5, 0-M, 45, 18.3-04, 94-M91
AExd IIC / AExe II Class I, Zone 1
UL2279, UL60079-0, UL60079-1, UL60079-7,
UL60079-1-1 E60079-0, E60079-1, E60079-7, E60079-1-1

Thread NPT Male: L1 +/-1 Turn

Gauging Female L1+1/2 to + 2 Turns

Material Brass Nickel Plated

Ingress Protection With Thread Sealant (Non-Hardening)
IP66/68 NEMA 4X

Impact Resistance 7Nm

Dimensions

Part Number	N.1/2.1/2.N
Male Thread	1/2" NPT-14
Thread Bore 'A'	0.571" (14.5mm)
Male Thread Length 'B'	0.787" (20.0mm)
Female Thread	1/2" NPT-14
Female Thread Depth 'C'	0.709" (18.0mm)
Body Height 'D'	1.496" (38mm)
Body Length 'E'	1.142" (29.0mm)
Body Width 'F'	1" (25.4mm)