

DATA SHEET:

# N.3/4.3/4.N

ADAPTOR

Ex approved adaptors are used to match enclosure entry threads with the cable gland or conduit when the threads differ, maintaining the hazardous location certificate and the overall integrity of the installations.



www.hlsus.com

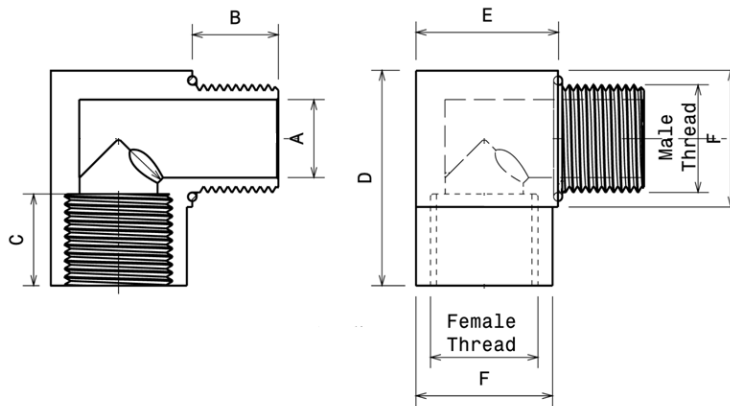

## Approvals & Specifications

ATEX/IEC	Exd IIC Gb / Exe IIC Gb / Extb IIIC Db, IP6X EN/IEC60079-0, EN/IEC60097-1, EN/IEC60079-7, EN/IEC60079-31, ATEX/2014/34/EU  II 2GD
NEC/CEC	Class I, Division 1, Groups ABCD Class II, Division 1, Groups EFG, Class III UL1203, UL514B, UL50 C22.2 Nos. 30, 0.5, 0-M, 45, 18.3-04, 94-M91 AExd IIC / AExe II Class I, Zone 1 UL2279, UL60079-0, UL60079-1, UL60079-7, UL60079-1-1 E60079-0, E60079-1, E60079-7, E60079-1-1
Thread	NPT Male: L1 +/-1 Turn
Gauging	Female L1+1/2 to + 2 Turns
Material	316 Stainless Steel
Plating	Passivated
Ingress Protection	With Thread Sealant (Non-Hardening) IP 66 68 NEMA 4X Without Thread Sealant IP54, NEMA 3
Impact Resistance	7Nm

## Dimensions

Part Number	N.3/4.3/4.S
Male Thread	3/4" NPT-14
Thread Bore 'A'	0.768" (19.5mm)
Male Thread Length 'B'	0.787" (20.0mm)
Female Thread	3/4" NPT-14
Female Thread Depth 'C'	0.709" (18.0mm)
Body Height 'D'	1.732" (44mm)
Body Length 'E'	1.378" (35.0mm)
Body Width 'F'	1.20" (30.48mm)